

M16

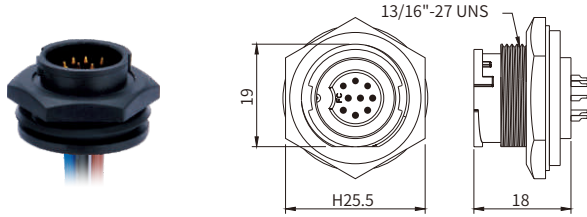

M16 Straight Connector, Panel Mount, Quick-lock Type, Solder, Front fastened

Male



RoHS

Female

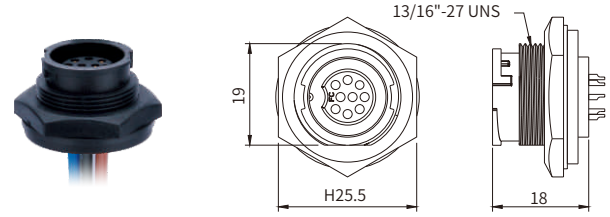

RoHS

Specifications

Contacts	8	9
Pin layout(Male)		
Pin layout(Female)		
Ambient temperature	-15°C~+85°C (flexible installation), -30°C~+85°C (fixed installation)	
Customized temperature	-25°C ~ +85°C (flexible installation), -40°C ~ +85°C (fixed installation)	
Connector insert	PA+GF	
Connector contacts	Brass with gold plated	
Coupling nut/screw	PA+GF	
Seal / O-ring	Epoxy resin / FKM	
Insulation resistance	≥100MΩ	
Contact resistance	≤5mΩ	
Earth tag/pin	Unavailable	
IP rating	IP65, IP67 in locked condition	
Mating endurance	>100 cycles	
Rated current	4A	
Rated voltage	250V AC / 300V DC	
Wire gauge	0.34mm (AWG22)	

Part Number

Pins	Cable length	Male	Female
8	0.1m	MB16MSAFQ08ST-3401	MB16FSAFQ08ST-3401
	0.3m	MB16MSAFQ08ST-3403	MB16FSAFQ08ST-3403
9	0.1m	MB16MSAFQ09ST-3401	MB16FSAFQ09ST-3401
	0.3m	MB16MSAFQ09ST-3403	MB16FSAFQ09ST-3403

Default wire colors

Pin No.		
Pin 1	WH	BK
Pin 2	BN	BN
Pin 3	GN	RD
Pin 4	YE	OR
Pin 5	GY	YE
Pin 6	PK	GN
Pin 7	BU	BU
Pin 8	RD	WH
Pin 9		GY

Panel Cut-out Dimensions

